



AEROSPACE



ASSEMBLY



AUTOMOTIVE



FOUNDRY

INDUSTRIAL CATALOG

Affordable, ergonomic solutions to reduce repetitive, stress injuries while increasing productivity.



MADE IN THE U.S.A.

For 31 years, Fortune 100 manufacturing companies have called on Honsa® to help them reduce injuries, increase productivity and provide affordable ergonomic solutions.

As the field of ergonomics continues to expand, Honsa's® dedication and relentless product design development exceeds the demanding challenges of our customers. Whether it is a new power tool, a custom driver to install parts or an ergonomic bucking bar, Honsa® creates the custom solutions you need.

The Honsa® engineering team approaches every project with your workers comfort, safety, and productivity in mind. Our "outside the box", custom engineering approach delivers solutions where it matters, in the hands of your workers.

When we help a customer improve safety, ergonomics, and productivity, we focus on these issues:

- Reducing injuries
- Improving productivity
- Continuous quality improvements
- Creating affordable, ergonomic solutions
- Creating a solution that operators will want to use

If your company is using pneumatic power tools in your processes, ask Honsa® to solve your most difficult tasks to improve productivity and lower injuries.

Together we can end those vibration related injuries that cause work stoppages, perpetuate employee turnover, increase insurance claims, and devastate company profits.

Best regards,

Thomas W. Honsa
President & CEO

CONTENTS

Riveting Tools	3-5
Bucking Bars	6-7
Assembly Tools	8-13
Custom Projects	14
Chipping Hammers	15
Weld Destruct Tools	16
Weld Destruct Kits	17
Chisels	18-19
Needle & Chisel Scalers	20-21
Accessories	20
Vertical Grinder	22
Right Angle Grinder	22
Isolators	23
Honsa® BIO-GREEN	24
Retrofit Handles	26-28
Suspension Bail	28
Honsa® Ergonomic Arm	29
Honsa® Manipulator	30



HTOP-38 SERIES

Riveting Tools

The P-38 series is lightweight, with a comfortable grip that fits 95% of the population and is easy-to-manage in tight spaces with an impressive power-to-weight ratio. Honsa® tools create a safer workplace by exposing operators to less vibration.

HTOP-38 Riveting Tools

.401 Shank

Model#	Bore	Stroke	BPM	O.A.L.	Weight	Capacity
HTOP-38 2X	1/2"	2 1/4"	2580	6 3/4"	2lbs 9oz	3/32"
HTOP-38 3X	1/2"	2 7/8"	2160	7 1/4"	2lbs 13oz	5/32"
HTOP-38 4X	1/2"	3 1/16"	1740	8 1/4"	3lbs 0oz	3/16"
HTOP-38 10	9/16"	1 7/8"	3200	6"	2lbs 10oz	1/8"
HTOP-38 12	9/16"	3"	2100	8"	3lbs 1oz	3/16"
HTOP-38 13	9/16"	4"	1725	9"	3lbs 13oz	1/4"
HTOP-38 10T*	9/16"	1 7/8"	3200	6"	2lbs 11oz	1/4"
HTOP-38 12T*	9/16"	3"	2100	8"	3lbs 3oz	5/16"
HTOP-38 13T*	9/16"	4"	1725	9"	3lbs 8oz	1/2"

* T denotes high powered Tungsten Piston

HTOP-38 10 shown with optional accessories



Standard Equipment

HTOP-38 2X 3X 4X

Beehive Retainer 4839
Mech Aid Retainer 4838

HTOP-38 10/10T 12/12T 13/13T

Beehive Retainer 6013
Mech Aid Retainer 6012

Optional Equipment

Suspension Bail HTPR-10
Isolator HTRB-4X13
Isolator HTRB3X12
Regulator HTRREG-2
Swivel HTO 1/4" SWIVEL



Riveting Tools

HTOP-51 SERIES

The HTOP-51 series tools strike a great balance; tough enough to handle demanding jobs, but not so tough they forget that's a human being on the trigger. They are lightweight with an aluminum, cast body that's easy to operate and comfortable to hold.



HTOP-51C

HTOP-51 Riveting Tools

.498 Shank

Model#	Bore	Stroke	BPM	O.A.L.	Weight
HTOP-51C	27/32"	6 ²³ / ₆₄ "	1400	10 ¹ / ₄ "	6lbs 2oz
HTOP-51D	27/32"	4 ³ / ₄ "	1400	9"	5lbs 6oz
HTOP-51E	27/32"	6 ²³ / ₆₄ "	1400	12 ¹ / ₂ "	7lbs 4oz

Standard Equipment

Beehive Retainer	8112
Mech Aid Retainer	8111

Optional Equipment

Suspension Bail	HTPR579
Turn Ball Bearing Retainer	8113R
Non-Turn Ball Bearing Retainer	8113
Barrel Isolator for C and E Barrels	HTSBO2C
Barrel Isolator for D Barrels	HTSBO2D
Swivel	HTO 1/4" SWIVEL



HTOP-51D

Riveting Tools

HTPB-17 SERIES

The HTPB-17 series tools are the gentle giants of Honsa® riveting tools. They have just enough weight and an abundance of power to ease through demanding applications for sustained periods of time, without the bone crushing vibration you would expect to find in a high-powered riveter.

HTPB-17 Riveting Tools .498 Shank Type

Model#	Bore	Stroke	BPM	O.A.L.	Weight
HTPB-17C	27/32"	6 ²³ / ₆₄ "	1400	15 ³ / ₈ "	8lbs 8oz
HTPB-17D	27/32"	4 ³ / ₄ "	1400	13 ³ / ₄ "	8lbs 3oz
HTPB-17E	27/32"	6 ²³ / ₆₄ "	1400	17 ¹ / ₂ "	9lbs 0oz
HTIBLB-17C	27/32"	6 ²³ / ₆₄ "	1400	17 ¹ / ₂ "	9lbs 0oz
HTIBLB-17D	27/32"	4 ³ / ₄ "	1400	16"	8lbs 0oz
HTIBLB-17E	27/32"	6 ²³ / ₆₄ "	1400	19"	11lbs 0oz



HTPB-17C



HTPB-17D



HTIBLB-17C



HTIBLB-17D

Riveting Tools

.498 Shank Type

Model#	Bore	Stroke	BPM	O.A.L.	Weight
HTP 5X	3/4"	2 ¹¹ / ₁₆ "	1560	12"	6lbs 12oz
HTP 9X	3/4"	3 ⁷ / ₈ "	1140	14"	7lbs 1oz
HTP 7X	3/4"	5 ¹³ / ₁₆ "	900	16"	7lbs 12oz

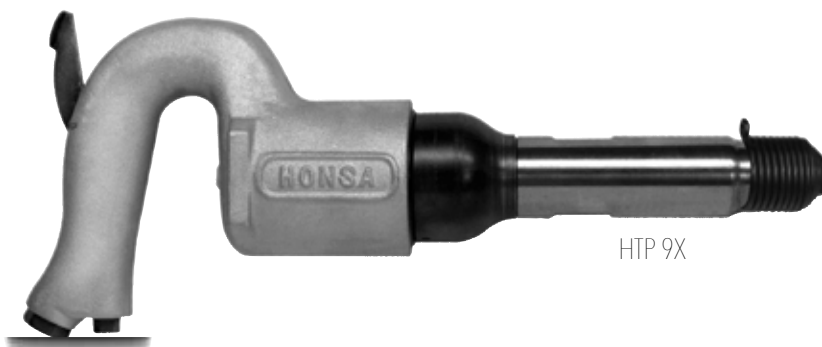

HTP 9X

Barrel Isolators

Tool	Isolator
HTPB-17C and E	HTSBO2C
HTIBLB-17D	HTSBO2D
HTP 7X	HTRB-79X
HTP 9X	HTRB-79X

Barrel Isolator With Collar

Tool	Isolator
HTPB17C and E	HTRB-C-B17
HTP 5X	HTRB-C5X
HTP 9X	HTRB-C79X
HTP 7X	HTRB-C79X

Tool	Isolator
HTP 5X	HTRB 5X

Made In the U.S.A.

ISOVIB™ Bucking Bars

HVRBB SERIES

**US PATENT #10,179,361
AND OTHER PATENTS PENDING**



HVRBB-001

Honsa® designs and manufactures standard and vibration reduced bucking bars from tungsten, steel and stainless steel. We offer isolated bucking bars in several configurations to minimize harmful vibration transmitted to operators.

Our ISOVIB™ modular bucking bar technology incorporates the benefits of steel, tungsten, urethane, and a robust spring to provide maximum vibration reduction in a weight best customized for your application. The ISOVIB™ bucking bar has a non-mar tip and a rivet height gauge which reduces over bucking and costly rework to skin surfaces.



UBB-2R
Static isolated bucking bar available in a wide variety of geometries to access difficult areas

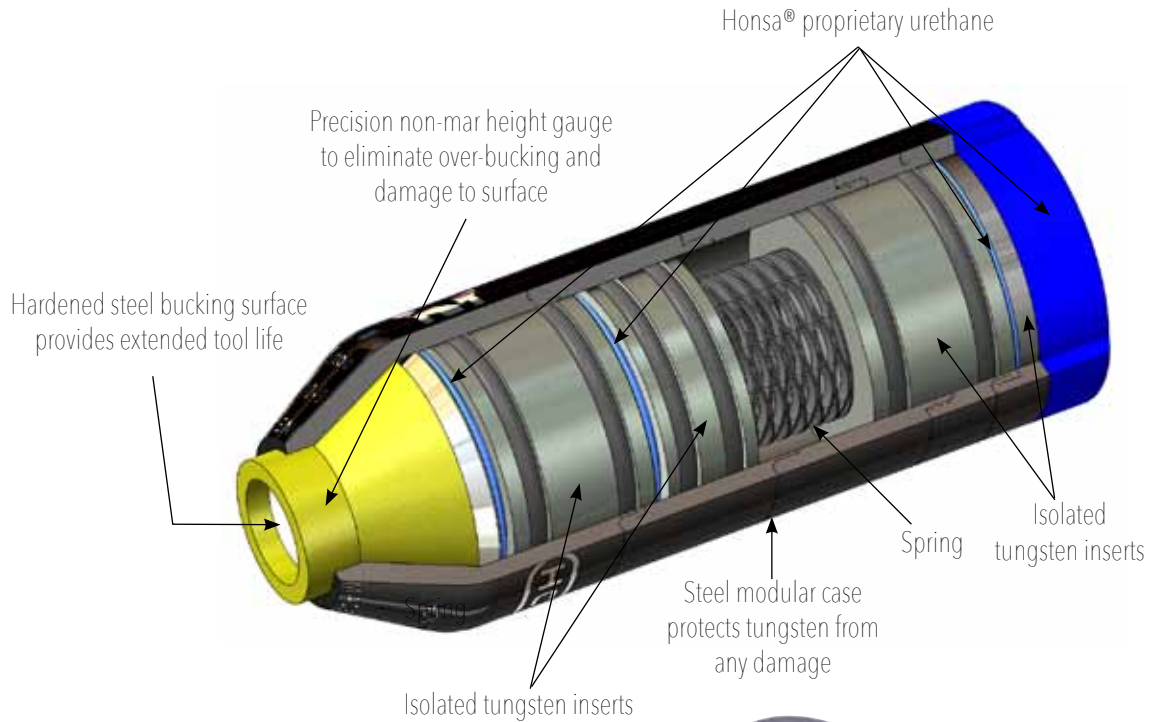

HVRBBs with custom dollies

Bucking Bars

- Currently, we offer over 300 bucking bar designs.
- Each design is available in the customer's choice of steel or tungsten.
- All Honsa® bucking bars are made in the USA from the highest quality materials available.
- Call us at 800-800-9371 or email us at engineering@honsatools.com to modify any of these for your application or to create a new design for your unique needs.

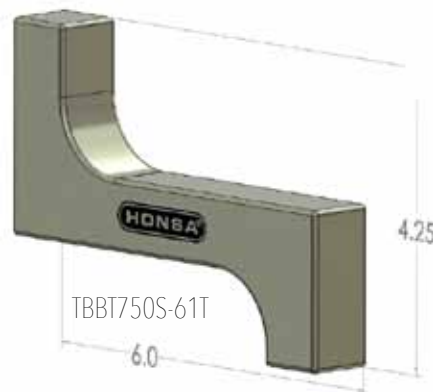
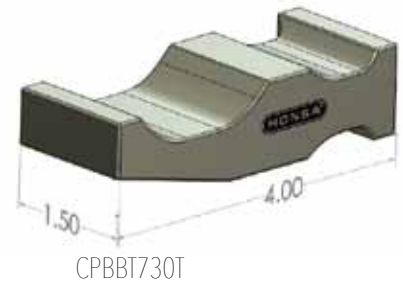

Assembly Tools

Traditional Offset Handle

.401 Shank Type

Model#	Bore	Stroke	BPM	O.A.L.	Weight
HTO 2X	1/2"	2 1/4"	2580	7"	3lbs 4oz
HTO 3X	1/2"	2 7/8"	2160	8"	3lbs 8oz
HTO 4X	1/2"	3 1/16"	1740	9"	3lbs 12oz



Offset Polymer Grip

.401 Shank

Model#	Bore	Stroke	BPM	O.A.L.	Weight
HTOP-38 2XB	1/2"	2 1/4"	2580	6 3/4"	2lbs 9oz
HTOP-38 3XB	1/2"	2 7/8"	2160	7 1/4"	2lbs 13oz
HTOP-38 4XB	1/2"	3 1/16"	1740	8 1/4"	3lbs 0oz



Inline Handle

.401 Shank Type

Model#	Bore	Stroke	BPM	O.A.L.	Weight
HTIBL 2X	1/2"	2 1/4"	2580	10"	3lbs 2oz
HTIBL 3X	1/2"	2 7/8"	2160	11"	3lbs 5oz
HTIBL 4X	1/2"	3 1/16"	1740	12"	3lbs 9oz



Gooseneck Handle

.401 Shank Type

Model#	Bore	Stroke	BPM	O.A.L.	Weight
HTP 2X	1/2"	2 1/4"	2580	10 1/2"	3lbs 13oz
HTP 3X	1/2"	2 7/8"	2160	11 1/2"	4lbs 1oz
HTP 4X	1/2"	3 1/16"	1740	12 1/2"	4lbs 5oz



Standard Equipment

2X 3X 4X

Beehive Retainer	4839
Mech Aid Retainer	4838
Inline Includes Bail	HTIL-BH1

Optional Equipment

Turn Ball Bearing Retainer	4840
Non-Turn Ball Bearing Retainer	4840
Suspension Bail Offset	HTO BH1
Barrel Isolator	HTRB 2X10
Barrel Isolator	HTRB 3X12
Barrel Isolator	HTRB 4X13
Regulator	HTREG-2
Swivel	HTO 1/4" SWIVEL

Assembly Tools

Traditional Offset Handle

.401 Shank Type

Model#	Bore	Stroke	BPM	O.A.L.	Weight
HTO 10	9/16"	17/8"	3200	6 1/2"	3lbs 4oz
HTO 12	9/16"	3"	2100	8 1/2"	3lbs 12oz
HTO 13	9/16"	4"	1725	9 1/2"	4lbs 0oz

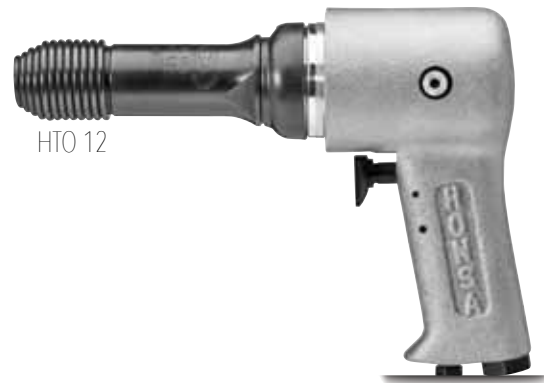

Offset Polymer Grip

.401 Shank

Model#	Bore	Stroke	BPM	O.A.L.	Weight
HTOP-38 10B	9/16"	17/8"	3200	6"	2lbs 10oz
HTOP-38 12B	9/16"	3"	2100	8"	3lbs 1oz
HTOP-38 13B	9/16"	4"	1725	9"	3lbs 13oz



Inline Handle

.401 Shank Type

Model#	Bore	Stroke	BPM	O.A.L.	Weight
HTIBL 10	9/16"	17/8"	3200	9"	3lbs 4oz
HTIBL 12	9/16"	3"	2100	11"	3lbs 12oz
HTIBL 13	9/16"	4"	1725	12"	4lbs 0oz



Gooseneck Handle

.401 Shank Type

Model#	Bore	Stroke	BPM	O.A.L.	Weight
HTP 10	9/16"	17/8"	3200	10"	3lbs 7oz
HTP 12	9/16"	3"	2100	12"	4lbs 7oz
HTP 13	9/16"	4"	1725	13"	4lbs 11oz



Standard Equipment

Beehive Retainer	6013
Mech Aid Spring Retainer	6012
Inline Bail Included	HTIL BH1

Optional Equipment

Turn Ball Bearing Retainer	6014
Non-Turn Ball Bearing Retainer	6014
Suspension Bail For Use With Offset Polymer Grip	HTPR 10
Suspension Bail For Traditional Offset	HTO BH1
Barrel Isolator	HTRB 2X10
Barrel Isolator	HTRB 3X12
Barrel Isolator	HTRB 4X13

Made in the U.S.A.

Assembly Tools

.498 Shank

²⁷/₃₂" Bore

Model#	Stroke	BPM	O.A.L.	Weight
HTOP-51C	6 ²³ / ₆₄ "	1400	10 ¹ / ₄ "	6lbs 2oz
HTOP-51CR	6 ²³ / ₆₄ "	1400	12 ¹ / ₂ "	7lbs 2oz
HTOP-51D	4 ²³ / ₆₄ "	1400	9"	5lbs 6oz
HTOP-51DR	4 ²³ / ₆₄ "	1400	10 ¹ / ₄ "	6lbs 6oz
HTOP-51E	6 ²³ / ₆₄ "	1400	12 ¹ / ₂ "	7lbs 4oz

.498 Shank Type

³/₄" Bore

Model#	Stroke	BPM	O.A.L.	Weight
HTIBL 5X	2 ¹¹ / ₁₆ "	1560	14 ¹ / ₂ "	10lbs 3oz
HTIBL 7X	5 ¹³ / ₁₆ "	900	17 ¹ / ₂ "	11lbs 3oz
HTIBL 9X	3 ⁷ / ₈ "	1140	15 ¹ / ₂ "	10lbs 10oz

Barrel Isolator With Collar

Tool	Isolator
HTP 5X	HTRB-C5X
HTP 9X	HTRB-C79X
HTP 7X	HTRB-C79X

Barrel Isolator Without Collar

Tool	Isolator
HTP 5X	HTRB 5X
HTP 7X	HTRB-7X
HTP 9X	HTRB-9X
HTOP-51C	SB02C
HTOP-51D	SB02D

Standard Equipment

Mech Aid Retainer Inline Bail Included	8111
Beehive Retainer	8112
Turn Ball Bearing Retainer	8113E

Optional Equipment

Suspension Bail	HTPR579
Turn Ball Bearing Retainer	8113R
Non-Turn Ball Bearing Retainer	8113
Regulator	HTREG-2
Swivel	HTO ¹ / ₄ " SWIVEL



Assembly Tools

B-17 Series .498 Shank Type

Model#	Bore	Stroke	BPM	O.A.L.	Weight	Standard Equipment
HTPB-17C	27/32"	6 ²³ / ₆₄ "	1400	15 ³ / ₈ "	8lbs 8oz	8112
HTPB-17CR	27/32"	6 ²³ / ₆₄ "	1400	17"	10lbs 3oz	8113R
HTPB-17D	27/32"	4 ³ / ₄ "	1400	13 ³ / ₄ "	8lbs 3oz	8112
HTPB-17DR	27/32"	4 ³ / ₄ "	1400	15 ¹ / ₂ "	9lbs 10oz	8113R
HTPB-17E	27/32"	6 ²³ / ₆₄ "	1400	17"	10lbs 3oz	8113E

Model#	Bore	Stroke	BPM	O.A.L.	Weight	Standard Equipment
HTIBLB-17C	27/32"	6 ²³ / ₆₄ "	1400	17 ¹ / ₂ "	9lbs 0oz	8112
HTIBLB-17CR	27/32"	6 ²³ / ₆₄ "	1400	19"	10lbs 0oz	8113R
HTIBLB-17D	27/32"	4 ³ / ₄ "	1400	16"	8lbs 0oz	8112
HTIBLB-17DR	27/32"	4 ³ / ₄ "	1400	17 ¹ / ₂ "	9lbs 2oz	8113R
HTIBLB-17E	27/32"	6 ²³ / ₆₄ "	1400	19"	11lbs 0oz	8113E



Assembly Tools

P38 Offset Polymer Grip .401 Shank

Model#	Bore	Stroke	BPM	O.A.L.	Weight
HTOP-38 2X	1/2"	2 1/4"	2580	6 3/4"	2lbs 8oz
HTOP-38 3X	1/2"	2 7/8"	2160	7 1/4"	2lbs 13oz
HTOP-38 4X	1/2"	3 1/16"	1740	8 1/4"	3lbs 0oz
HTOP-38 10	9/16"	1 7/8"	3200	6"	2lbs 10oz
HTOP-38 12	9/16"	3"	2100	8"	3lbs 1oz
HTOP-38 13	9/16"	4"	1725	9"	3lbs 5oz
HTOP-38 10B	9/16"	1 7/8"	3200	6"	2lbs 10oz
HTOP-38 12B	9/16"	3"	2100	8"	3lbs 1oz
HTOP-38 13B	9/16"	4"	1725	9"	3lbs 5oz

* B denotes Tuff Grip material



2X/3X/4X Tools Standard Equipment

Beehive Retainer	4839
Mech Aid Spring Retainer	4838

Optional Equipment

Turn Ball Bearing Retainer	4840
Non-Turn Ball Bearing Retainer	4840
Suspension Bail Offset	HTPR 10
Regulator	HTREG-2
Swivel	HTO 1/4" SWIVEL

10/12/13 Tools Standard Equipment

Beehive Retainer	6013
Mech Aid Spring Retainer	6012

Optional Equipment

Ball Bearing Retainer	6014
Suspension Bail	HTPR 10
Suspension Bail Offset	HTO BH1
Barrel Isolator	HTRB 2X10
Barrel Isolator	HTRB 3X12
Barrel Isolator	HTRB 4X13
Regulator	HTREG-2
Swivel	HTO 1/4" SWIVEL

Retainer Options



Beehive

4839
6013
8112



Mechanical
Aid Retainer

4838
6012
8111



Ball Bearing Retainer

4839 - Turn and Non-Turn
6012 - Non-Turn Type
6014 - Turn Type
7210 - Turn Type
7211 - Non-Turn
8113 - Non-Turn
8113R - Turn Type
8113E - Turn Type

Air Hammer Series

.401 Shank

.498 Shank

.432 Hex

Model#	Bore	Stroke	BPM	O.A.L.	Weight	Handle
HTO 72	3/4"	2 1/4"	3000	7 3/4"	3 lbs 10 oz	Offset
HTO 472	3/4"	4"	1500	9 3/4"	5 lbs 8 oz	Offset
HTP 72	3/4"	2 1/4"	3000	11"	4 lbs 6 oz	Pistol Grip
HTP 472	3/4"	4"	1500	13"	6 lbs 3 oz	Pistol Grip
HTIBL 72	3/4"	2 1/4"	3000	11"	4 lbs.1 oz	Inline
HTIBL 472	3/4"	4"	1500	13"	5 lbs 7 oz	Inline
HTO 85	3/16"	4"	3250	8"	4 lbs 4 oz	Offset
HTP 85	3/16"	4"	3250	12 1/2"	5 lbs 6 oz	Offset
HTIBL 85	3/16"	4"	3250	12"	4 lbs 4 oz	Offset



HTO 85

HTO 72

Standard Equipment

Beehive Retainer	6013
Mech Aid	6012
HTIL-BH1 Inline Tool Bail Included	

Optional Equipment

Suspension Bail	HTPR 72
Ball Bearing Retainer (.401 Shank)	6014
Turn Ball Bearing Retainer (.489 Shank)	7210
Non-Turn Ball Bearing Retainer (.489 Shank)	7211
Regulator	HTREG-2
Swivel	HTO 1/4" SWIVEL

This series of air hammers can be ordered for use with .401, .498 or .432 shank chisels.



HTP 472



HTP 85



HTIBL 85

HTIBL 472

Custom Engineered Solutions

Many times there isn't an off-the-shelf solution for a particular manufacturing challenge. Honsa® offers unique design/build solutions that draw on our decades of experience and extensive component arsenal. Our contribution to your solution can include:

- Needs Analysis
- Design
- 3D Printing
- Prototyping
- Short Run Manufacturing
- Process Optimization

Problem solving runs deep in the DNA of Honsa® (it's how the company was founded) and we take particular pleasure in developing affordable, ergonomic solutions.

To find out more, call 800-800-9371 or email engineering@honsatools.com.

HET-4002
Mod 2



Non-Mar Surface Tip



HET-6513
Axle Bearing Driver



Non-Mar Surface Tip

HET-123
Weatherstrip Installation Driver



HUB CAP
Driver Assembly

Non-Mar Surface Tip



HET-3263
Driver

Non-Mar Surface Tip



HET10071 with HTOP51CR Flag Pin driver



HET10010
Ball Plug Driver



HETJDT1028
Plug Driver Assembly

Vibration Reduced Chipping Hammer

Features

- Lower vibration
- Lighter in weight
- Ergonomically designed handles
- Increased productivity
- Increased power and efficiency on work surface
- Easier chisel control onto work surface
- Improved safety and ergonomics
- No metal-to-metal contact between handle and barrel provides lower vibration



HTC 11-4-R



HTC 41-4-R
Shown With 9345PA Pipe Away Exhaust



HTP-B25

Standard Equipment

Oval Collar Retainer SR93

Optional Equipment

Round Collar Retainer SR93RC
 Barrel Isolator with collar HT9500
 Barrel Isolator without collar HT9501
 $\frac{3}{8}$ " Swivel HTC SWIVEL
 Quick Change Retainer 93SR0034
 Piped Away Exhaust - 41 Series 9345PA
 Suspension Bail Hangers HTC BHIR
 HTC BHIRV
 Urethane Retainer Spring CH400
 Steel Retainer Spring SR93S

Spool Valve Chipping Hammer

1-1/8" Bore

.680 Round Chisel Shank Style

	Stroke	BPM	O.A.L.	Weight	Handle
HTC 11-2-R	2½"	1800	17"	15lbs 14oz	Gooseneck
HTC 11-3-R	3½"	1600	18"	16lbs 14oz	Gooseneck
HTC 11-4-R	4½"	1400	19"	17lbs 14oz	Gooseneck

1-1/8" Bore

.580 Hex Chisel Shank Style

	Stroke	BPM	O.A.L.	Weight	Handle
HTC 11-2-H	2½"	1800	17"	15lbs 14oz	Gooseneck
HTC 11-3-H	3½"	1600	18"	16lbs 14oz	Gooseneck
HTC 11-4-H	4½"	1400	19"	17lbs 14oz	Gooseneck

Simple Valve Chipping Hammer

.680 Round Chisel Shank Style

	Bore	Stroke	BPM	O.A.L.	Weight
HTC 41-1-R	1⅛"	1"	2820	15½"	12lbs
HTC 41-2-R	1⅛"	2"	2400	16½"	13lbs
HTC 41-3-R	1⅛"	3"	1920	18½"	14lbs
HTC 41-4-R	1⅛"	4"	1500	19½"	15lbs

.580 Hex Chisel Shank Style

	Bore	Stroke	BPM	O.A.L.	Weight
HTC 41-1-H	1⅛"	1"	2820	15½"	12lbs
HTC 41-2-H	1⅛"	2"	2400	16½"	13lbs
HTC 41-3-H	1⅛"	3"	1920	18½"	14lbs
HTC 41-4-H	1⅛"	4"	1500	19½"	15lbs

HTP B25 Series Chipping Hammer

	Bore	Stroke	BPM	O.A.L.	Weight
HTP-B25H	7/8"	2⅞"	3500	14"	8lbs
HTP-B25R	7/8"	2⅞"	3500	14"	8lbs
HTIBL-B25H	7/8"	2⅞"	3500	14"	8lbs
HTIBL-B25R	7/8"	2⅞"	3500	14"	8lbs

Inline Handle Series Chipping Hammer

.680 Round Chisel Shank Style

	Bore	Stroke	BPM	O.A.L.	Weight
HTIBL11-2-R	1⅛"	2½"	1800	19¼"	15lbs 2oz
HTIBL11-3-R	1⅛"	3½"	1600	16½"	16lbs 4oz
HTIBL11-4-R	1⅛"	4½"	1400	21½"	17lbs 4oz

.580 Hex Chisel Shank Style

	Bore	Stroke	BPM	O.A.L.	Weight
HTIBL11-2-H	1⅛"	2½"	1800	19¼"	15lbs 2oz
HTIBL11-3-H	1⅛"	3½"	1600	16½"	16lbs 4oz
HTIBL11-4-H	1⅛"	4½"	1400	21½"	17lbs 4oz

Made in the U.S.A.

1300 11th Street West | Milan, IL 61264 | Tel: 309.756.0200 | Fax: 309.756.0700 | Toll Free 800.800.9371 | www.honsatools.com

Weld Destruct Tools

Honsa® makes the most productive weld destruct tools anywhere, created specifically to go through the tough boron and dual phase steel used in automobile structures of today.

.498 Round Shank

.432 Hex Shank

Model#	Bore	Stroke	BPM	O.A.L.	Weight	Handle
HTO 85	13/16"	4"	3250	9"	4lbs 0oz	Offset
HTP 85	13/16"	4"	3250	12 1/2"	4lbs 9oz	Gooseneck
HTPB-17CR	27/32"	6 23/64"	1400	17"	10lbs 3oz	Gooseneck
HTPB-17DR	27/32"	6 23/64"	1400	15 1/2"	9lbs 10oz	Gooseneck
HTPB-17E	27/32"	6 23/64"	1400	17"	10lbs 3oz	Gooseneck
HTOP-51CR	27/32"	6 23/64"	1400	12 1/2"	7lbs 2oz	Offset
HTOP-51DR	27/32"	4 3/4"	1400	10 1/4"	6lbs 6oz	Offset
HTOP-51E	27/32"	6 23/64"	1400	12 1/2"	7lbs 4oz	Offset

1-1/8" Bore

.680 Round Chisel Shank Style

	Stroke	BPM	O.A.L.	Weight	Handle
HTC 11-2-R	2 1/2"	1800	17"	15lbs 14oz	Gooseneck
HTC 11-3-R	3 1/2"	1600	18"	16lbs 14oz	Gooseneck
HTC 11-4-R	4 1/2"	1400	19"	17lbs 14oz	Gooseneck

1-1/8" Bore

.580 Hex Chisel Shank Style

	Stroke	BPM	O.A.L.	Weight	Handle
HTC 11-2-H	2 1/2"	1800	17"	15lbs 14oz	Gooseneck
HTC 11-3-H	3 1/2"	1600	18"	16lbs 14oz	Gooseneck
HTC 11-4-H	4 1/2"	1400	19"	17lbs 14oz	Gooseneck

.401 Shank

Model#	Bore	Stroke	BPM	O.A.L.	Weight	Handle
HTO 2XWT	1/2"	2 1/4"	2580	7"	3lbs 13oz	Offset
HTO 3XWT	1/2"	2 7/8"	2160	8"	4lbs 1oz	Offset
HTO 4XWT	1/2"	3 1/16"	1740	9"	4lbs 5oz	Offset
HTP 2XWT	1/2"	2 1/4"	2580	10 1/2"	3lbs 13oz	Gooseneck
HTP 3XWT	1/2"	2 7/8"	2160	11 1/2"	4lbs 1oz	Gooseneck
HTP 4XWT	1/2"	3 1/16"	1740	12 1/2"	4lbs 5oz	Gooseneck

.401 Shank

Model#	Bore	Stroke	BPM	O.A.L.	Weight	Handle
HTO 10WT	9/16"	1 7/8"	3200	6 1/2"	3lbs 9oz	Offset
HTO 12WT	9/16"	3"	2100	8 1/2"	4lbs 1oz	Offset
HTO 13WT	9/16"	4"	1725	9 1/2"	4lbs 5oz	Offset
HTP 10WT	9/16"	1 7/8"	3200	10"	4lbs 1oz	Gooseneck
HTP 12WT	9/16"	3"	2100	12"	3lbs 12oz	Gooseneck
HTP 13WT	9/16"	4"	1725	13"	3lbs 12oz	Gooseneck



HTOP-51E



HTPB-17E



HTC 11-4R

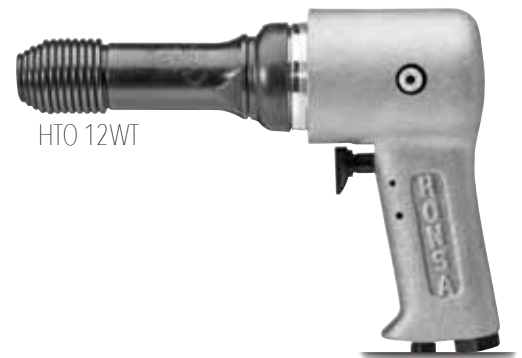

HTO 12WT

Weld Destruct Kits



SWDK Weld Destruct Kit

HTO P51 E	Medium Duty
HTO 85 .498S	Light Duty
HET 97-8	.498 Expansion Chisel
HET 26-1	.498 Expansion Chisel
CH 959	Panel Cutter
Ball Bearing 7210	Retainer



XLWDK Weld Destruct Kit

HTC 11-4R	Heavy Duty
HTO P51 E	Medium Duty
HTP B17 E	Medium Duty
HET-36	.680 Fork Chisel
HET-97-8	.498 Fork Chisel
HET-122	.680 Expansion Chisel
HET-26-1	.498 Expansion Chisel



LWDK Weld Destruct Kit

HTP B17 E	Medium Duty
HTO P51 E	Medium Duty
HET 97-8	.498 Expansion Chisel
HET 26-1	.498 Expansion Chisel

To help take the guesswork out of weld destruction tool selection, Honsa® offers three ready-to-go kits, with tools and accessories paired to match the job and metal gauge at hand. Whether it is boron or dual phase steel, our customers report these kits address all their weld destruct needs effectively.

If you don't see exactly what you need, contact Honsa® to create a kit with your choice of chisels and tools to best suit your needs.

Weld Destruct Chisels

CS 401 .401 Shank Style Chisel Set (includes case) O.A.L.

CH 910	3/4" x 6 1/2" Chisel	16 5/8"
CH 932	Kwik Cutter	8 1/2"
CH 909	Double Blade Panel Cutter	6"
HET 27-1	Custom Expansion Chisel	10"

.401 Shank Style Chisels

CH 119	.401 Chisel 30 Degree Bend	10 1/4"
CH 909	.401 Double Blade Panel Cutter	6"
CH 910	.401 3/4" x 6 1/2" Chisel	6 3/8"
CH 914	.401 Spot Weld Breaker	6 1/4"
CH 932	.401 Kwik Cutter	8 1/2"
HET 27-1	.401 Custom Expansion Chisel	10"
HET 98	.401 Fork Splitter	10 3/4"

.498 Shank Style Chisels

CS 498 .498 Shank Chisel Set (includes case)

CH 955	.498 Wide Chisel Scraper	7"
CH 959	.498 Double Panel Cutter	7"
CH 960	.498 5/8"x7" Chisel	7"
HET 26-1	.498 Shank Expansion Chisel	9"
HET 97	.498 Shank Fork	11"
HET 97-8	.498 Shank Fork	8"
HET 26-12	.498 Shank Expansion	12"

.680 Round Shank Style Chisels

CH 313	.680 Round Shank Moil Point	9"
HET 36	.680 Round Shank Fork Tool	11"
HET 56	.680 Round Shank Round Collar Chisel	7"
HET 122A	.680 Round Shank Oval Collar Chisel	10"
HET 50	.680 Round Shank Round Collar Chisel	11"
HET 51	.680 Round Shank 10mm Fork Chisel	11"
HET 57	.680 Round Shank Round Collar Chisel	11"

.580 Hex Shank Style Chisels

HET 34	.580 Hex Shank Fork Tool	11"
HET 28	.580 Hex Shank Fork Tool	7"

CS LG Large Chisel Set consisting of: (includes case)

CH 909	.401 Double Blade Panel Cutter	6"
CH 910	.401 3/4" x 6 1/2" Chisel	6 3/8"
CH 932	.401 Kwik Cutter	8 1/2"
CH 955	Wide Chisel Scraper	7"
CH 959	.498 Double Panel Cutter	7"
CH 960	.498 5/8" x 7" Chisel	7"
HET 26-1	.498 Expansion Tool	9"
HET 27-1	.401 Expansion Tool	10"



Weld Destruct Chisels

The right chisel with the right tool makes all the difference! It's best to let Honsa® do the work. Select the correct chisel to extend tool life and improve productivity. Do not pry with chisels.



HET 97-8A
.498 Fork Chisel
8" O.A.L.
With 30° Bend



HET 126
.680 Round OCRS Fork Chisel
10½" O.A.L.
With 30° Bend



HET 159
.498 Shank Slim Fork Chisel
8" O.A.L.
This chisel is great for the narrow-spaced spot welds.



HET 159-A
.498 Shank Slim Fork Chisel
8" O.A.L.
With 30° Bend
Made for narrow-spaced spot welds.



HET 34B
.580 Hex OCHS
11" O.A.L.
With 30° Bend



HET 54
.498 Wedge Fork
13¼" O.A.L.



HET 55
.580 Hex OCHS
14¾" O.A.L.
Expansion Offset



HET 84
.580 Hex OCHS
15" O.A.L.
Expansion Offset



CH 919
.498 Flat Blade
14¼" O.A.L.
30° Bend



HET 97-8 Fork Expansion Chisel separating layers of metal, popping the weld nuggets.



HET 26-1 Single Tine Expansion Chisel separating layers of metal, popping the weld nuggets.

We also offer a variety of weld destruct kits suitable for many different applications. Custom configurations are available.

Needle Scalers

These tools are ideal for removing weld spatter, rust, paint, gaskets, etc. in hard to reach areas. Also ideal for chipping and cleaning small castings. The ergonomic handles make it easier to maneuver and reduces a large portion of vibration.

Octagon Shank Needle Scaler 4000 BPM 1 ⁵ / ₁₆ " Bore 1 ¹ / ₁₆ " Stroke 1/4" Inlet	Model	Handle	O.A.L.	Weight
	HTP 182N7	Gooseneck	22"	8lbs 11oz
	HTIL 182N7	Inline	19"	6lbs 8oz
	HTIP 182N7	Push To Start	20"	7lbs 3oz

Standard Equipment

HTIL-182N7	includes 19 9043 7" needles
HTP-182N7	includes 19 9043 7" needles
Inline Vertical Suspension Bail	HTIL-BH1

1/2" Square Shank Needle Scaler 4600 BPM 1" Bore 1 ¹ / ₈ " Stroke 1/4" Inlet	Model	Handle	O.A.L.	Weight
	HTP 356N7	Gooseneck	22"	8lbs 14oz
	HTIL 356N7	Inline	19"	6lbs 11oz
	HTIP 356N7	Push To Start	20"	7lbs 6oz

Optional Equipment

Horizontal or Vertical Suspension Bail	HTPS-182
Horizontal or Vertical Suspension Bail	HTPS-356



HTP356N7



HTIL 182N7

Accessories



HTREG
Regulator



HTREG-2
Regulator



HTO-1/4
SWWSQ



HTO
1/4 SWIVEL



HTC
SWIVEL



SR93 RC
Round Collar
Retainer



93SR0034
Quick Change
Retainer



WH-1224
WH-1424
WH-3824

Chisel Scalers



HTP F100A

**Square Shank
Chisel Scaler**
4000 BPM
1" Bore
2" Stroke
1/4" Inlet

Model	Handle	O.A.L.	Weight
HTP F100S	Goosneck	17"	7lbs 0oz
HTIL F100S	Inline	14"	4lbs 13oz
HTIL F100S	Inline	14"	5lbs 13oz



HTIL F100S

HTIL 356

**Octagon Shank
Chisel Scaler**
4000 BPM
15/16" Bore
1 1/16" Stroke
1/4" Inlet

Model	Handle	O.A.L.	Weight
HTP 182	Goosneck	15"	6lbs 6oz
HTIL 182	Inline	12"	4lbs 3oz
HTIP 182	Push To Start	13"	4lbs 14oz



HTIP 182

**1/2" Square Shank
Chisel Scaler**
4600 BPM
1" Bore
1 1/8" Stroke
1/4" Inlet

Model	Handle	O.A.L.	Weight
HTP 356	Goosneck	15"	6lbs 10oz
HTIL 356	Inline	12"	4lbs 6oz
HTIP 356	Push To Start	13"	5lbs 2oz

**1/4" Octagon Shank
Chisel Scaler**
4300 BPM
15/16" Bore
1" Stroke
1/4" Inlet

Model	Handle	O.A.L.	Weight
HTP 456	Goosneck	15"	6lbs 6oz
HTIL 456	Inline	12"	4lbs 3oz



HTP 182

Features

- Ergonomically designed handle
- Lighter in weight
- Reduced vibration
- Increased productivity
- Increased power-to-weight ratio
- Easier chisel control on work surface
- No metal to metal contact between handle and barrel reduces vibration

Optional Equipment

Barrel Isolator (356)	HTSB01
Barrel Isolator (182)	HTSB02
Regulator	HTREG-2
Swivel	HTO 1/4" SWIVEL



HTIL182 with HTSB02 isolator



HTP 356

3 Horsepower Vertical Grinder

Standard Handle

	Weight	Guard Type
HTVG36-6	10lbs 6oz	6" Cup
HTVG37-6	9lbs 6oz	7" Depressed Center
HTVG39-6	10lbs 4oz	9" Depressed Center

Safety Lockout Handle

	Weight	Guard Type
HTVG36-S-6	10lbs 6oz	6" Cup Wheel Guard
HTVG37-S-6	9lbs 6oz	7" Depressed Center
HTVG39-S-6	10lbs 4oz	9" Depressed Center

Standard Equipment

Wheel Guard	6", 7" or 9"
2" Wrench	VG3-0145

Optional Equipment

Vertical Suspension Bail	HTVG-BH1V
Horizontal Suspension Bail	HTVG-BH1H
5" Wheel Guard	VG3-35-5
6" Wheel Guard	VG3-36-6
7" Wheel Guard	VG3-37-7
9" Wheel Guard	VG3-39-9
Muffler	VG-M
Tune-Up Kits	VG3TUK
Tune-Up Kit Complete	VG3TUKL
Tune-Up Kit Partial	VG3TUKS



High performance grinder with low vibration levels.

Honsa® tools are hand assembled and tested prior to shipment to insure the maximum governed speed of 4500, 6000 or 7200 RPM. Be sure to specify your desired speed at time of order.

- Safety lockout lever available.
- Easy maintenance and motor removal.
- Lifetime warranty on heavy-duty governor.
- Comfortable hand grips to reduce additional vibration.
- Patented isolation system – reducing vibration to hands and arms of operators: improved productivity and greater safety.
- Isolation system damps vibration using polyurethane elastomer.
- Rugged and durable.

Right Angle Grinder

Model	Wheel Size	RPM	Spindle	O.A.L.	HP	Weight	Air Cons.	Air Hose
HTRA-12	4½"	12,000	5/8"-11	11 1/8"	1.2	5lbs 8oz	33CFM	3/8"
HTRA-12S	4½"	12,000	3/8"-24	11 1/8"	1.2	4lbs 8oz	33CFM	3/8"
HTRA-12-3	4½"	12,000	5/8"-11	11 1/8"	1.2	5lbs 8oz	33CFM	3/8"
HTRA-12S-3	4½"	12,000	3/8"-24	11 1/8"	1.2	4lbs 8oz	33CFM	3/8"

- Honsa® polyurethane, vibration isolation system blocks harmful vibration from reaching operator.
- Honsa® E-Comfort Grip further reduces vibration transmission to reduce operator fatigue.
- ERGOS/H1 heavy-duty helical gear transmission minimizes vibration, enhances operator comfort, quieter under load, while dramatically improving tool life.
- Ergonomically designed handle reduces operator fatigue.
- Directional exhaust muffler is rotatable for optimum operator comfort.
- Adjustable heavy-duty safety guard.
- High torque governed motor for faster, smoother material removal and longer abrasive life.
- Military grade aluminum castings for exceptional durability.



Vibration Reducing Isolators

Riveter Barrel Isolators

Model#	Tool Type	I/D	O/D	O.A.L.
HTRB 5X	5X Series	1½"	2"	2¾"
HTRB 7X	7X Series	2"	1½"	3¼"
HTRB 9X	9X Series	2"	1½"	3¼"
HTRB 2X10	CP 2X	1½"	1½"	1½"
	AVC 10	1½"	1½"	1½"
HTRB 3X12	CP 3X	1½"	1½"	2"
	AVC 12	1½"	1½"	2"
HTRB 4X13	CP 4X	1½"	1½"	3"
	AVC 13	1½"	1½"	3"
HTRB C 5X	5X Series	1½"	2" Hand 4" Collar	2"
HTRB C 79X	7 & 9 Series	1½"	2" Hand 4" Collar	4¾"
HTRB C B17	B-17C,D; P51C,E	1 ⁴³ / ₆₄ "	2"	3 ³ / ₁₆ "
HTSBO2-C	B-17C, P-51C	1 ³ / ₉ "	2"	3¼"
HTSBO2-D	B-17D, P-51D	1 ³ / ₉ "	2"	1¼"

Independent research documents vibration transmitted through percussive tools and chisels cause a variety of long term health and safety issues. Our isolators are intended for use when an operator uses a two-hand grasp on the tool. Isolators are installed over the barrel or chisel and utilize our polyurethane technology to reduce harmful vibration to the operators forward hand, much like we do with our low vibration handles.



HTP7X with HTRB-C-79X isolator



HTC11 with HT9500 isolator

Chipping Hammer Barrel Isolators

Model#	Tool Type	I/D	O/D	O.A.L.
HT9500	11 and 41 Series Includes Protective Collar	2¼"	2¾" Hand 4½" Collar	4"
HT 9501	11 and 41 Series	2¼"	2¾"	3¼"

Scaler Barrel Isolators

Model#	Tool Type	I/D	O/D	O.A.L.
HTSBO1	356, BR, B1, 9356	1 ¹³ / ₂₀ "	2 ³ / ₂₀ "	5¼"
HTSBO2	456, 182, B-17	1 ⁵ / ₉ "	2"	5½"



HTIL182 with HTSBO2 isolator



Chisel Isolators

Model#	Tool Type	I/D	O/D	O.A.L.
HT 8000 CH	Hex, Round Shank	9/10"	1½"	4"
HT 8000 1R .498"-.401" Round	5/8" Round	5/8" Round	1"	4"
HT 8000 138R .498"-.401" Round	5/8" Round	5/8" Round	1 ³ / ₈ "	5"
HT 8000 1	½" Square	½" Square	1"	4"
HT 8000 138	½" Square	½" Square	1 ³ / ₈ "	4"

Chisels produce the highest frequency vibration in a tool. Our isolators reduce these high frequency vibrations before reaching the operator.

Bio-Green Lubricant

BIO-GREEN AIR TOOL LUBRICANT

The **Honsa® BIO-GREEN** air tool lubricants are made from a renewable food source; vegetable oils.

This unique and environmentally friendly formulation demonstrates an important solution for all companies using air tools. The **Honsa® BIO-GREEN** revolutionary formulations provide better lubricity than petroleum based oils when it comes to natural lubricity.

Our formulation is so environmentally safe, it is considered food grade.

Excellent Lubricity
Renewable Resource
Environmentally Safe
Operator Healthy



4 oz

1 Quart

Honsa® BIO-GREEN

Model#	Size
BIO-GREEN-4	4oz. Bottle
BIO-GREEN-CASE	Case of 12 - 4oz. Bottles
BIO-GREEN	1 Quart Size

LARGER SIZES AVAILABLE BY REQUEST:

- 5 gallon pails
- 30 gallon drums
- 55 gallon drums

Companies come to us to reduce injuries.

More than thirty years ago, our mission was to make tools that favored the operator. Tools that didn't leave operators numb at the end of a shift and in pain at the end of a career. That emerging practice became known as ergonomics, and it wasn't always an easy sell.

They stay for the productivity.

The companies that took a chance on us also found something else; tools that are designed and built to protect operators, last longer and provide a great return on investment.

A large manufacturing customer of Honsa® completed a comprehensive study and found that tools from Honsa® are among the most productive they use, including an average life cycle cost of just \$.045 per shift.



HONSA®

Retrofit Handles That Fit Riveters

A quick and efficient way to convert existing tools is to use the Honsa® Retrofit Handle Kit. These retrofit handles easily install onto existing tools which reduce the vibration levels transferred to the operator.



HTP 123
Gooseneck



HTP 234
Gooseneck



HTP 26
Gooseneck



HTP 579
Gooseneck



HTIBL123 and 234
Inline Lever

NEW PRODUCT

Polymer handle uses industrial grade urethane for extended comfort and lower vibration levels. Ergonomic grip design accurately fits 95% of all human hands.



P3800X
Offset

P3800
P3800B

Ingersoll Rand Riveters

Model	Handle Type	Fits
P3800	Offset	AVC 10
		AVC 12
		AVC 13
P3800B	Tuff Grip	AVC 10
		AVC 12
		AVC 13
HTO 6011	Offset	AVC 10
		AVC 12
		AVC 13
HTP 123	Gooseneck	AVC 10
		AVC 12
HTP 26	Gooseneck	AVC 13
		AVC 26
HTP KH	Gooseneck	AVC 27
		K2LA
HTIBL 123	Inline Lever	AVC 10
		AVC 12
		AVC 13

Chicago Pneumatic Riveters

Model	Handle Type	Fits
P3800X	Offset	CP444 2X
		CP444 3X
		CP444 4X
		CP444 4X
HTO 4830	Offset	CP444 2X
		CP444 3X
		CP444 4X
		CP444 4X
HTP 234	Gooseneck	CP444 2X
		CP444 3X
HTP 579	Gooseneck	CP444 4X
		CP4447 5X
HTIBL 234	Inline Lever	CP4447 7X
		CP4447 9X
		CP444 2X
		CP444 3X
		CP444 4X

Sioux Riveters

Model	Handle Type	Fits
P3800B	Offset	Sluggar 270
		Sluggar 270A
HTO 6011	Offset	Sluggar 270
		Sluggar 270A
HTP 123	Gooseneck	Sluggar 270
		Sluggar 270A
HTIBL 123	Inline Lever	Sluggar 270
		Sluggar 270A



HTO6011
Offset

Retrofit Handles That Fit Chipping Hammers & Riveters

Honsa® Retrofit Handles are the perfect solution for converting your existing conventional air tools into low vibration tools your operators will want to use. Honsa® retrofit handles are easily installed on a variety of tools to reduce the harmful vibration levels transferred to the operator. Honsa® is the only manufacturer to offer a built in isolation system that is completely maintenance free and has a lifetime warranty.

Honsa® Retrofits:

- ATP
- Atsco
- Chicago Pneumatic
- Cleco
- Eagle
- Florida Pneumatic
- Ingersoll-Rand
- Jet Air Tools
- Jupiter Pneumatic
- Sioux
- Sullair
- Taylor
- Texas Pneumatic
- Thor
- Toku
- Many other brands!

Features

- Reduced vibration
- Lighter in weight
- Ergonomically designed handles
- Increased productivity
- Increased power and efficiency
- No metal to metal contact between handle and surface
- Retrofits existing chipping hammers
- Quick and easy installation – **OR send us the tool for "NO COST" installation!**



HTC 9370
Gooseneck



HTC 6970
Gooseneck



HTC 4870
Gooseneck



Honsa® vibration lowering isolation system, with no metal-to-metal contact of power system to operators hands

Atsco

Model#	Fits
HTC 6970	TC10, 20, 30

Chicago Pneumatic Chipping Hammers

Model#	Fits
HTC 9370	CP9362, 9363, 9364
HTC 4870	CP4123 1", 2", 3", 4"
HTC 4120	CP4125 1", 2", 3", 4"
	CP4125 1", 2", 3", 4" Ring Valve

Deutsch Chipping Hammers

Model#	Fits
HTC 9370	CP 9362, 9363, 9364 TX CH2, CH3, CH4

Ingersoll Rand Chipping Hammers

Model#	Fits
HTC 9370	IR "A" Series 1", 2", 3", 4" IR "W" Series 1", 2", 3", 4"

Rotor Chipping Hammers

Model#	Fits
HTC 6970	CH15, 20

Toku

Model#	Fits
HTC 3470	THA-1B, 2B, 3B, 4B

Honsa® offers retrofit handle solutions for many other brands of tools not listed above. Contact us to discuss retrofitting your current tools with our vibration reducing system.

Made In the U.S.A.

Retrofit Handles That Fit Scalers

Honsa® patented features make our tools the operators' choice, hands down.

Cleco Scalers

Model	Handle Type	Fits
HTP 18	Gooseneck	B1-C, BR-C
HTIL 18	Inline Lever	B1-C, BR-C
HTIP 18	Push-to-Start Throttle	B1-C, BR-C

Ingersoll Rand Scalers

Model	Handle Type	Fits
HTP 18	Gooseneck	182 Scaler
HTIL 18	Inline Lever	182 Scaler
HTIP 18	Push-to-Start Throttle	182 Scaler

Chicago Pneumatic Scalers

Model	Handle Type	Fits
HTP 18	Gooseneck	9356
HTIL 16	Inline Lever	CP456
HTIL 18	Inline Lever	9356
HTIP 18	Push-to-Start Throttle	9356



HTP 16 & 18
Gooseneck



HTIL 16 & 18
Inline Lever

Honsa® offers retrofit handle solutions for many other brands of tools not listed above. Contact us to discuss retrofitting your current current tools with our vibration reducing system.

Suspension Bails

A series of suspension tool bails that provide your operators with a higher level of comfort. By installing overhead rail and tool balancers combined with Honsa® tools and bails, operator muscle fatigue is significantly reduced. Honsa's® tool bails can be used with the following Honsa® vibration reduced air tools.

Vertical Grinders	Gooseneck Scalers
Chipping Hammers	Rivet Hammers
Inline Scalers	Weld Destruct Tools

Model #	Fits Honsa® Tool
HTPR-72	"72", "472" series Gooseneck Handle & Offset Air Hammers used horizontally - Rotates 360°
HTPS-356	Inline and Gooseneck Handle "356" series scalers used horizontally - Rotates 360°
HTPS-F100	Inline and Gooseneck Handle "F100A" series scalers used horizontally - Rotates 360°
HTPS-456	Inline and Gooseneck Handle "456" series scalers used horizontally - Rotates 360°
HTPS-182	Inline and Gooseneck Handle "182" series scalers used horizontally - Rotates 360°
HTPR-579	All Honsa® HTP-5X, HTP-7X, HTP-9X Riveters used horizontally - Rotates 360°
HTC-BH1R	All Honsa® Chipping Hammers used horizontally - Rotates 360°
HTO-BH1	All Honsa® Offset Riveters/Air Hammers used horizontally
HTIL-BH1	All Honsa® Inline Riveters/Inline Scalers used vertically
HTIP-BH1	All Honsa® Push-To-Start Scalers used vertically
HTVG-BH1-H	Honsa® Vertical Grinders used horizontally
HTVG-BH1-V	Honsa® Vertical Grinders used vertically
HTPR-10	All Honsa® 10, 12, 13 Tools
HTPRB17	All Honsa® B17 and P-51 Tools used horizontally



HEA

For those applications that require the operator to hold a heavy tool for extended periods of time or the need to achieve superior product quality output is desired but a traditional suspension system is not possible due to work station constraints, the NEW bench-mount, or magnetic-mount Honsa® Ergo Arm (HEA) with the exclusive Honsa® Gyro-Bail (GB) is just the solution.

Enjoy zero-gravity, enhanced tool maneuverability within the work envelope. Whether it's a chipping, grinding or scaling application, let Honsa® assist your workers in obtaining a higher level of productivity and an improved quality of task accomplishment resulting in increased corporate profits.



Ergo Arm
Gyro Bail



Ergo Arm
Grinder



Weight Range
0-77 lbs

Maximum Reach
68"

Vertical Distance
45"

(measurements apply only to the HEA shown)

Made In the U.S.A.

Honsa[®] Manipulator

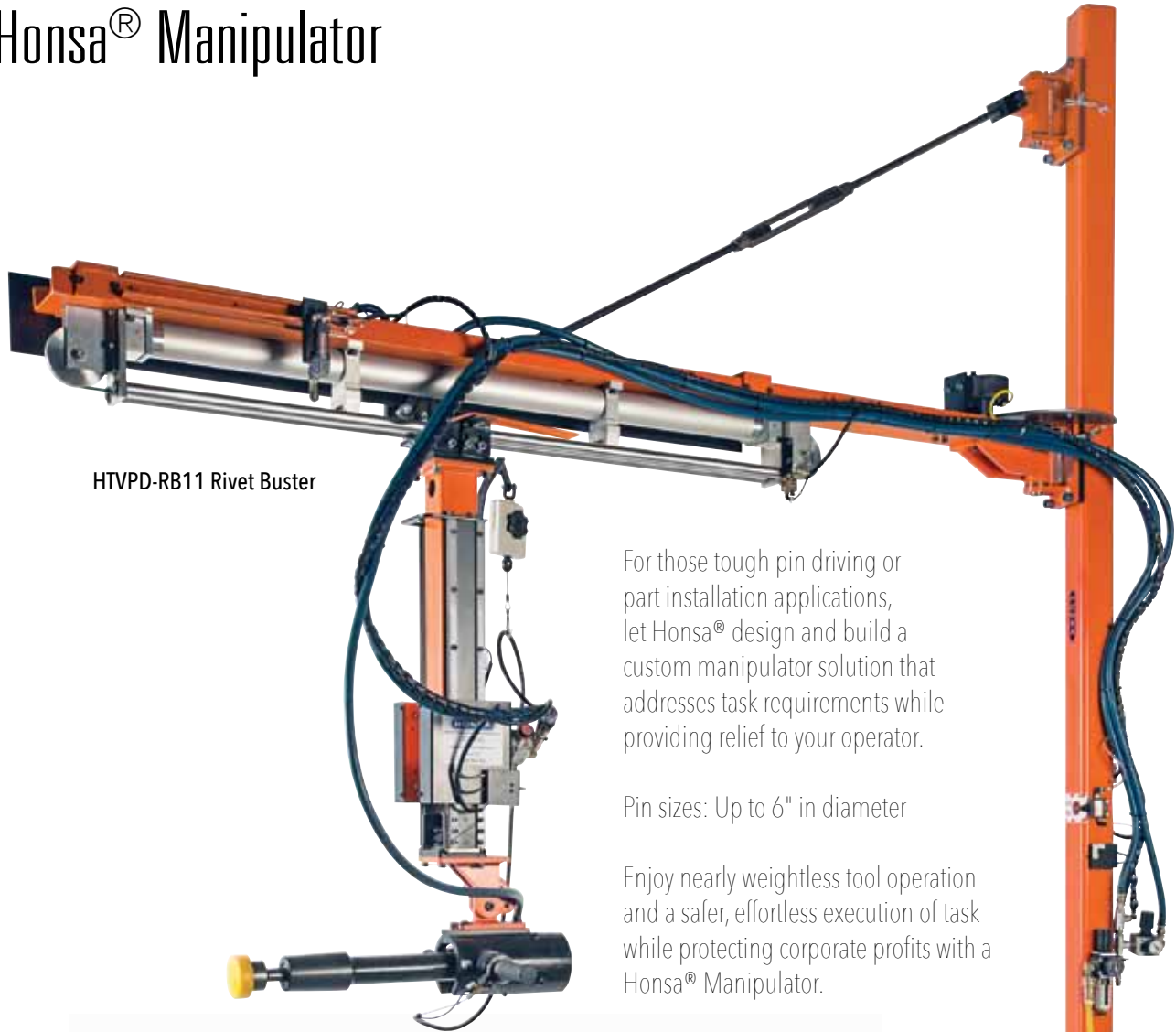

HTVPD-RB11 Rivet Buster

For those tough pin driving or part installation applications, let Honsa[®] design and build a custom manipulator solution that addresses task requirements while providing relief to your operator.

Pin sizes: Up to 6" in diameter

Enjoy nearly weightless tool operation and a safer, effortless execution of task while protecting corporate profits with a Honsa[®] Manipulator.



Honsa[®] Low-Pro with HTVPD

Full Muscular Skeletal Disorder (MSD) exposure

Energy absorbed through soft tissue

Energy absorbed by glove

Mid-sized Tools

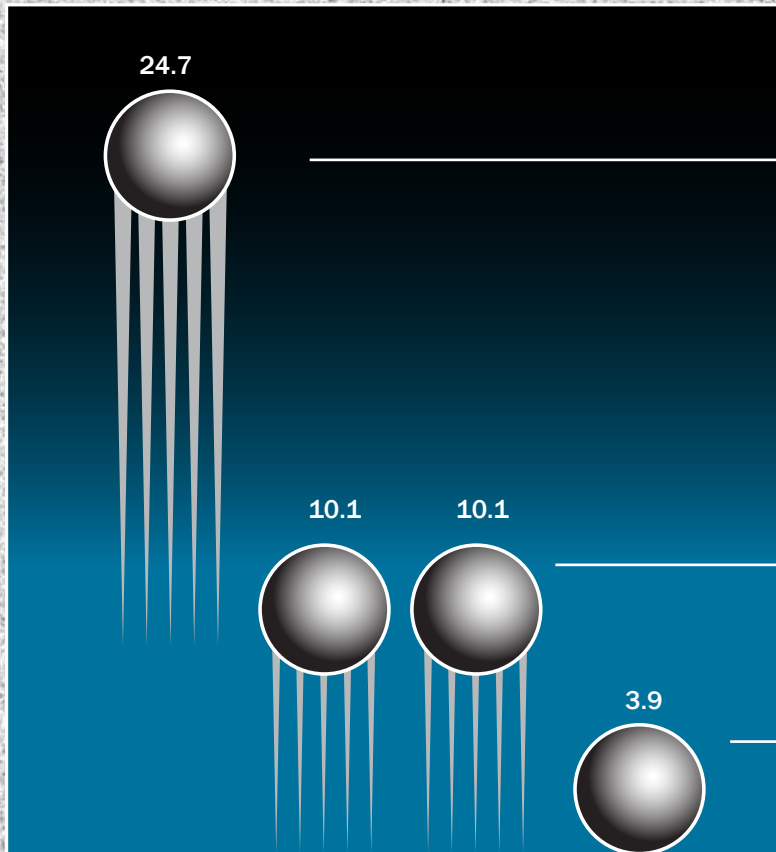

Tool A

Tool B

Tool C

HONSA HTPB-17CR

Measuring Acceleration



m/s^2

The SI unit of acceleration is the meter per second squared (m/s^2); this can be called more meaningfully "meter per second per second", as the velocity in meters per second changes by the acceleration value, every second.

3 HP Vertical Grinders

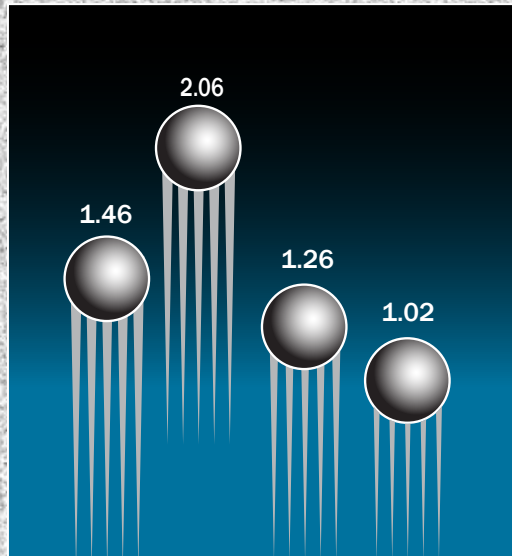

Tool A

Tool B

Tool C

HONSA HTVG-37

Large Sized/Heavy Use Tools

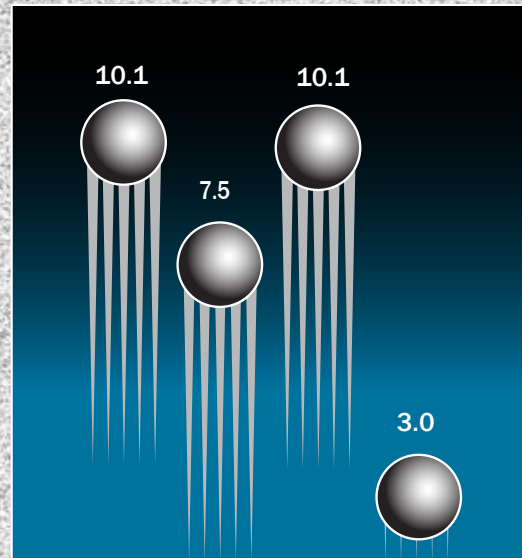

Tool A

Tool B

Tool C

HONSA HTC 11-4R

Data shown for Honsa® tools determined by third party professional laboratory. Other tool data supplied by individual manufacturers and deemed reliable but not verifiable.



It's popular to say, "Made in America."

It's so popular some companies have taken to hanging that label on their products without much thinking about it.

Here's what we think:

- Made in America does not mean cast in China, machined in Timbuktu and assembled by a state-side kit-shop.
- A product must have the best which is in us before we proclaim that it was Made in America. Given a choice of products, it must be the product we would personally choose.
- Products labeled Made in America have a standard greater than just patriotism and feeling good about the employment rate. A product labeled Made in America is an ambassador to other countries and establishes the standards by which we, and future generations, will be perceived.

Registered Trademarks. All product names, whether or not appearing in large print or with the registered trademark symbol, are registered trademarks of Honsa® Ergonomic Technologies, Inc. unless otherwise noted. All other registered trademarks, service marks, and logos (hereinafter "Marks") used in this catalog are the Marks of their respective owners. The use or misuse of these Marks or any other materials, except as permitted herein, is expressly prohibited and may be in violation of copyright law, trademark law, the law of slander and libel, the law of privacy and publicity, and communications regulations and statutes. Please be advised that Honsa® actively and aggressively enforces its intellectual property rights to the fullest extent of the law.

The following is a partial list of Honsa's® registered trademarks: Honsa® and blue/white logo, B-17, HTP and HTO. The term "Honsa" is a trademark of Honsa® Ergonomic Technologies, Inc.

Patents. Honsa® Ergonomic Technologies, Inc. spends thousands of dollars each year in discovery, development, acquisition and protection of its products. Much of the company's technology is protected by U.S. and foreign patents. A patent provides protection for the Company's exclusive use and development of certain product technology and methodologies for a specific period of time. The following is a partial list of United States (US) patents that Honsa® Ergonomic Technologies, Inc. owns or licenses for its products: US #D590,224; US #7,401,662; US #7,610,968; US #8,522,895; and US #10,179,361. In addition, other US and foreign patents are pending on the company's products, technologies and services. Please be advised that Honsa® Ergonomic Technologies, Inc. actively and aggressively enforces its intellectual property rights to the fullest extent of the law.

Printed in USA

Entire contents ©2019, Honsa® Ergonomic Technologies, Inc.

